

# Installation instructions

## SOLITEX FRONTA® QUATTRO FB

### Installation steps



#### 1. Install the membrane

Roll out the membrane and use galvanised staples that are at least 10 mm (3/8") wide and 8 mm (5/16") long to fasten the membrane in the overlap area in a manner that protects against moisture at intervals of 10-15 cm (4"-6").

Install the membrane to stop approx. 4 cm (2") short of adjacent building components so that a windtight bond can be applied here subsequently.



#### 2. Overlap the membranes

Clean the subsurface (dry and free of dust, silicone and grease). Overlap the membranes by approx. 10 cm (4") so that they are watertight. The printed markings are an aid to orientation.



#### 3. Stick overlaps using 'connect' adhesion technology

Stick membrane overlaps using 'connect' membranes with two integrated self-adhesive zones. Rub tape firmly into place using the pro clima PRESSFIX. Ensure that there is sufficient resistance pressure.



#### 4. Alternatively: Taping over the overlaps with TESCON INVIS

Tape TESCON INVIS system adhesive tape centrally to the overlap and stick it down bit by bit so that it is load and wrinkle free. Rub tape firmly into place using the pro clima PRESSFIX. Ensure that there is sufficient resistance pressure.



**5. Sticking to rough or mineral surfaces (e.g. floorboard)**

Clean the surface. Apply a bead of ORCON F system adhesive – at least 5 mm (3/16") thick (more in the case of very rough surfaces). Lay the membrane with an expansion joint and not pressing the tape down completely to allow for movement of the parts.

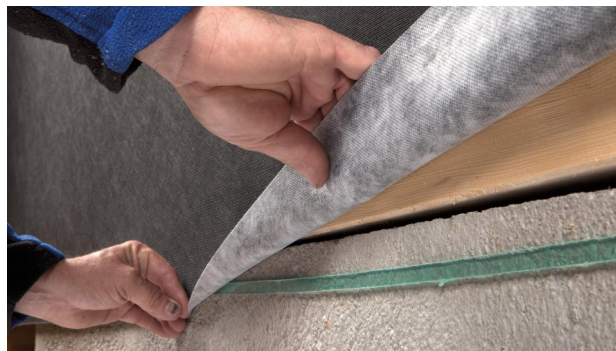

**6. Alternatively: Sticking to rough or mineral surfaces (e.g. floorboard)**

Stick line of adhesive to the subsurface, remove release film and stick the membrane in place, leaving slack to allow for expansion.

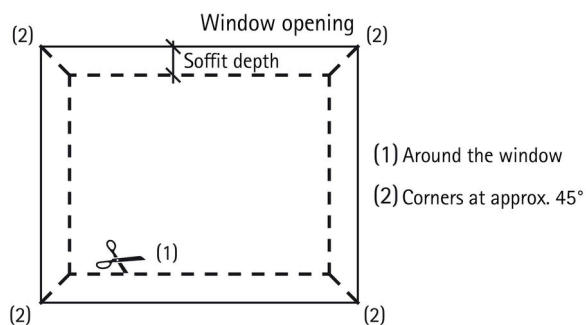

**7. Sticking to windows**

In the case of recessed windows, cut into the membrane as shown in the sketch and guide into the reveal as far as the frame.



**8. Sticking to windows**

Stick the membrane to the window frame so that it is windtight using TESCON PROTECT. Thanks to the split release paper it is possible to stick the tape first to the membrane and then, subsequently, to the window. Alternatively, use TESCON INVIS.



**9. Sticking to cables and pipes**

Place KAFLEX or ROFLEX sealing grommets over the cable or pipe and stick to the membrane. In the case of large gap widths, stick over the blue cable grommet using TESCON INVIS. Tape the pipe grommets to the membrane with TESCON INVIS.

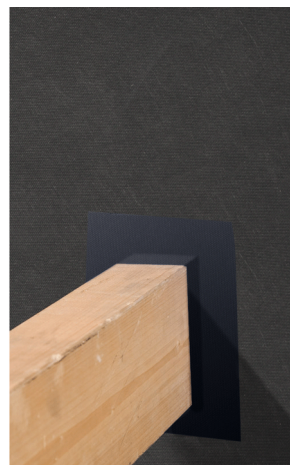
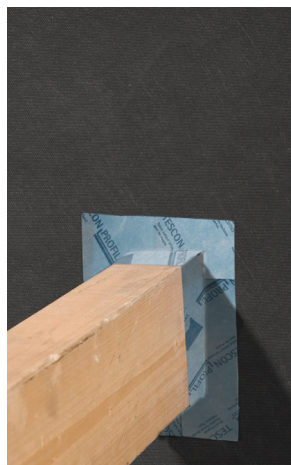

**10. Corner sealing**

Corner adhesive tape TESCON PROTECT with split release paper for angles. Prefold the tape into an L-shape, remove the first release paper and stick down the first side. Then remove the remaining film and stick down the second side. Alternatively, use TESCON INVIS.

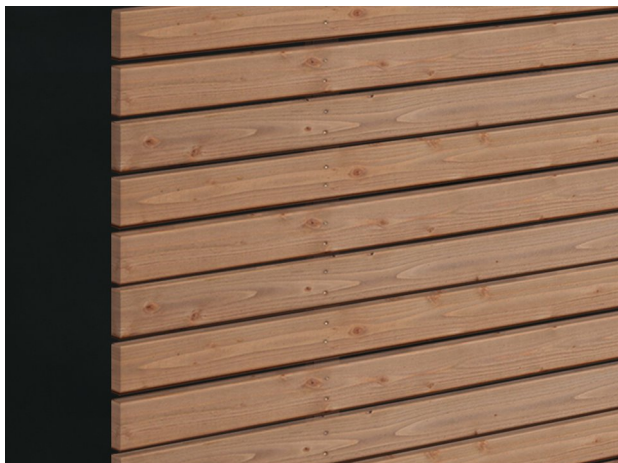

## 11. Installation of decking

Horizontal or vertical installation of decking –

SOLITEX FRONTA WA: Only for closed decking

SOLITEX FRONTA QUATTRO: For open cladding with gap widths up to max. 35 mm (1 3/8")

SOLITEX FRONTA QUATTRO FB: Flame-retardant

SOLITEX FRONTA PENTA: For open cladding with gap widths up to max. 50 mm (2")

## General conditions

SOLITEX FRONTA QUATTRO FB membranes should be installed with the black side facing outwards. The membranes are to be installed horizontally in a taut manner with no sagging.

When the product is used behind open-jointed cladding, the gap may be a maximum of 35 mm (1 3/8"). The width of cladding pieces must be at least three times the gap width. The distance between the open-jointed cladding and the membrane must be at least 20 mm (7/8").

Fasteners may not be applied in areas where water run-off is collected.

Additional measures (e.g. covering with tarpaulins) should be taken during the construction phase in the case of buildings that are lived in or buildings that are to be given particular protection. Covering with tarpaulins should also be considered if construction work is to be interrupted for a longer period.

---

The information provided here is based on practical experience and the current state of knowledge. We reserve the right to make changes to the recommended designs and processing or to make alterations due to technical developments and associated improvements in the quality of our products. We would be happy to inform you of the current technical state of the art at the time you use our products.

Further information about the application and construction can be found in the pro clima planning documentation. For queries please call the pro clima technical hotline on +49 (0)6202 278245.

---

### MOLL

**bauökologische Produkte GmbH**

Rheintalstraße 35 - 43

D-68723 Schwetzingen

Fon: +49 (0) 62 02 - 27 82.0

eMail: [info@proclima.de](mailto:info@proclima.de)